

Welcome!

Geography and Environmental Planning

-We're on level TWO of the CLA building-

2300 room #'s

2100 room #'s

2200 room #'s

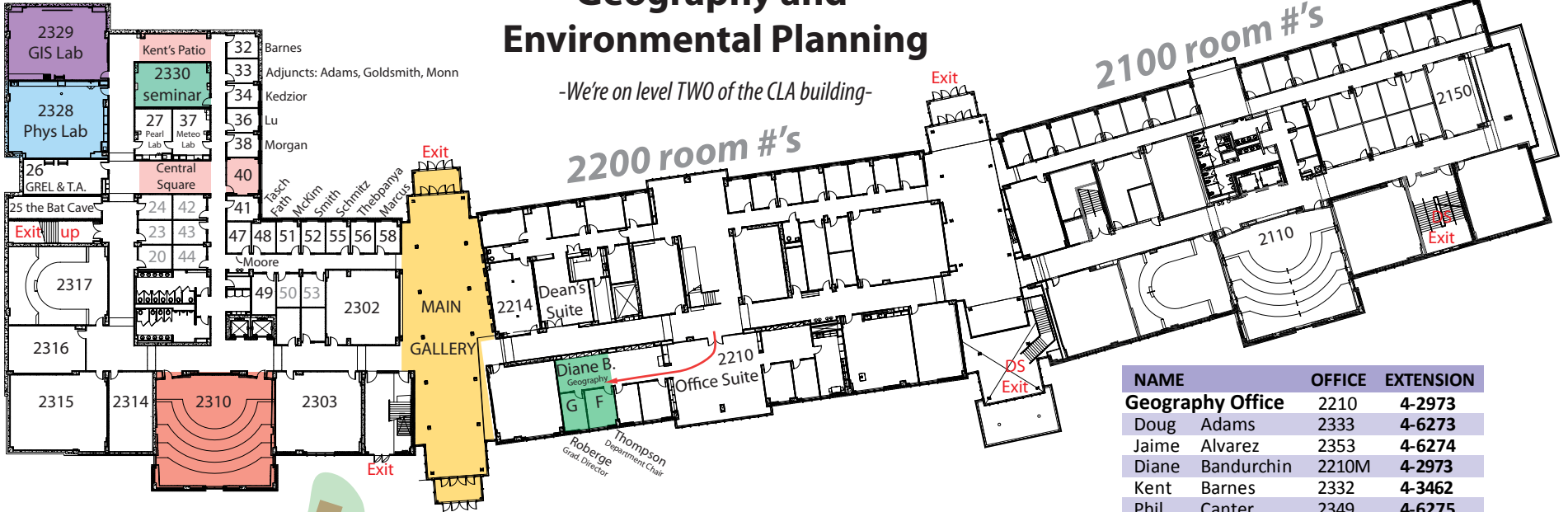

NAME	OFFICE	EXTENSION
Geography Office	2210	4-2973
Doug Adams	2333	4-6273
Jaime Alvarez	2353	4-6274
Diane Bandurchin	2210M	4-2973
Kent Barnes	2332	4-3462
Phil Canter	2349	4-6275
Brett Collins	UU111A	4-3518
Karna Couch	2349	4-6275
Natalia Fath	2348	4-2971
Doug Goldsmith	2333	4-6273
Charles Goodman	2353	4-6274
GREL	2326	4-3407
Sya Kedzior	2334	4-3192
Jon Lesh	2333	4-6273
Shou Lu	2336	4-3691
Alan Marcus	2358	4-2970
Wayne McKim	2351	4-2968
Jeremy Monn	2333	4-6273
Todd Moore	2347	4-3973
John Morgan III	2338	4-2964
Ingrid Pfoertsch	3349	4-2973
Phil Reese	2326	4-3407
Martin Roberge	2210G	4-5011
Yulia Savva	2349	4-6275
Charles Schmitz	2355	4-2966
Henry Schupple	2353	4-6274
James Smith	2352	4-4620
T.A. Office	2326	4-3407
Jeremy Tasch	2341	4-4270
Virginia Thompson	2210F	4-4371
Paporn Thebpanya	2356	4-4665

North

Campus Map

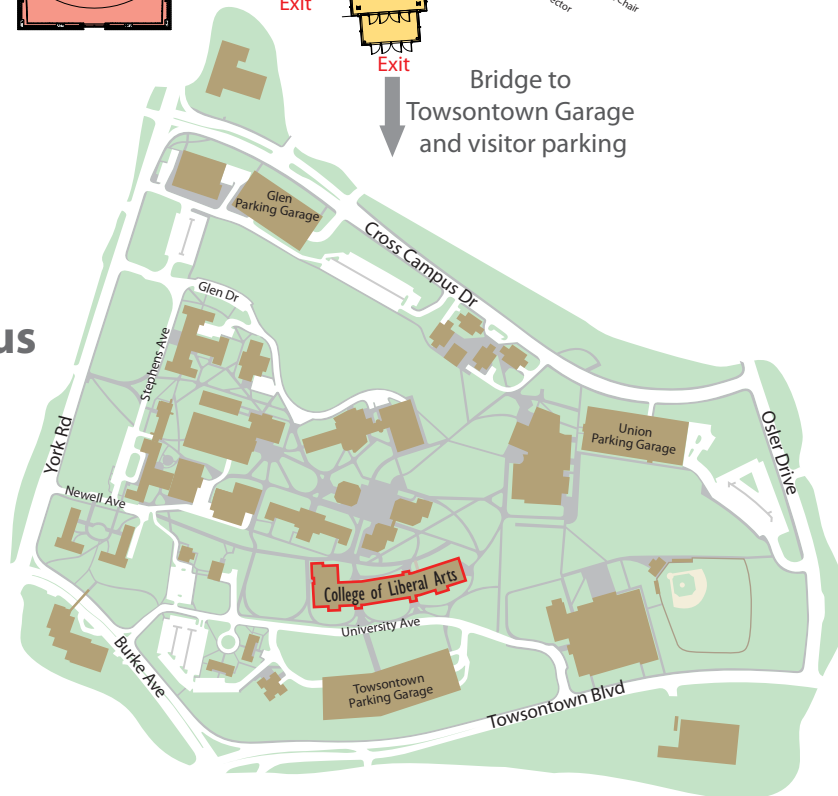

Visitors can use the pay meter on the lower level of the Towsontown Garage parking map: <http://www.towson.edu/main/maps/index.asp?id=TTPG>
 print this map: <http://pages.towson.edu/mroberge/GeographyBuildingMap.pdf>